

6mm Round Bath Screens

6mm Square Bath Screens

INSTALLATION INSTRUCTIONS

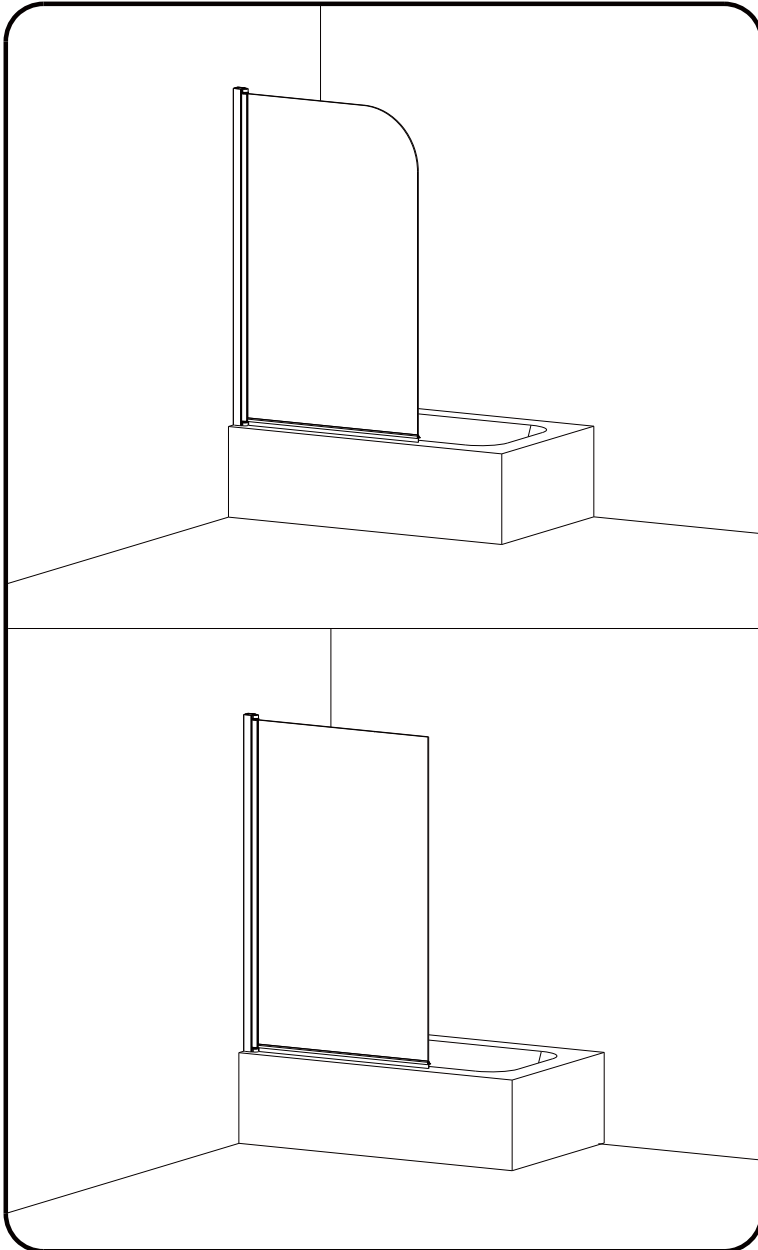

Tools Required



Drill

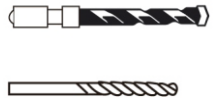

6mm Masonry Drill
3.2mm HSS Drill



Spirit level

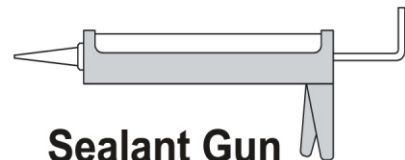

Sealant Gun

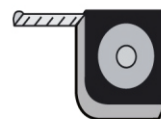

Tape Measure



Pencil



**PH2 TYPE
Screwdriver**

Please not hand tools **NOT** supplied.

IMPORTANT

These instructions assume that installation is done against solid/tiled walls.

The wall plugs supplied with the installation kit are for use on solid walls. Hollow or stud-partition walls will require alternative fixings. Please consult with a reputable trades person or hardware supplier for the correct type of fixing.

It may also be necessary to consult your tiling supplier about the correct method drilling your tiles.

Components And Box Contents

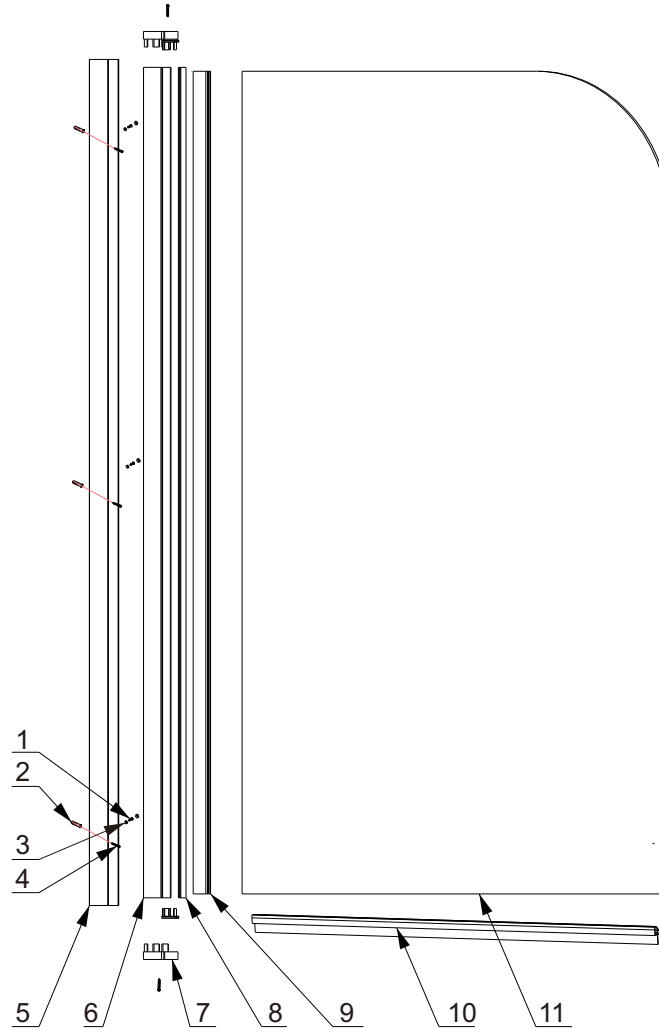

NO.	Code	Description	Qty	NO.	Code	Description	Qty
1	MLBSRD/SQ-01	Screw M4*10	3	7	MLBSRD/SQ-07	Hinge	2
2	MLBSRD/SQ-02	Wall Plug	3	8	MLBSRD/SQ-08	Vertical Seal	1
3	MLBSRD/SQ-03	Screw cover Caps	5	9	MLBSRD/SQ-09	Fixed Profile B	1
4	MLBSRD/SQ-04	Screw M4*30	3	10	MLBSRD/SQ-10	Bottom Seal	1
5	MLBSRD/SQ-05	Wall Profile	1	11	MLBSRD/SQ-11	Moving Glass Panel	1
6	MLBSRD/SQ-06	Fixed ProfileA	1				

Round Bath Screens

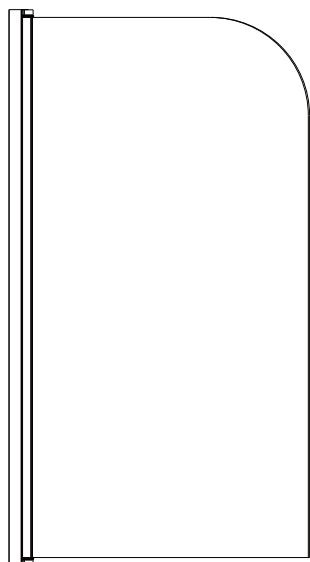

Square Bath Screens

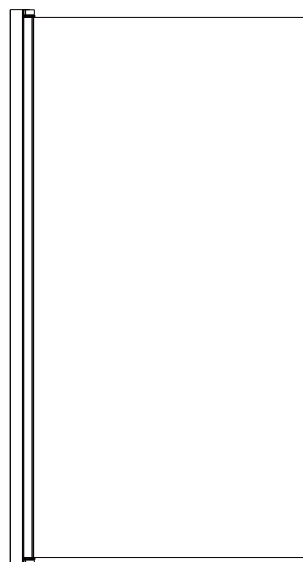

Or

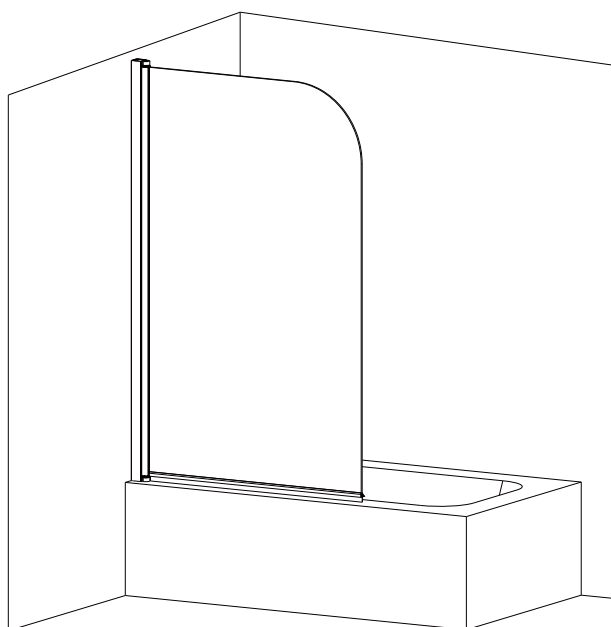

Left

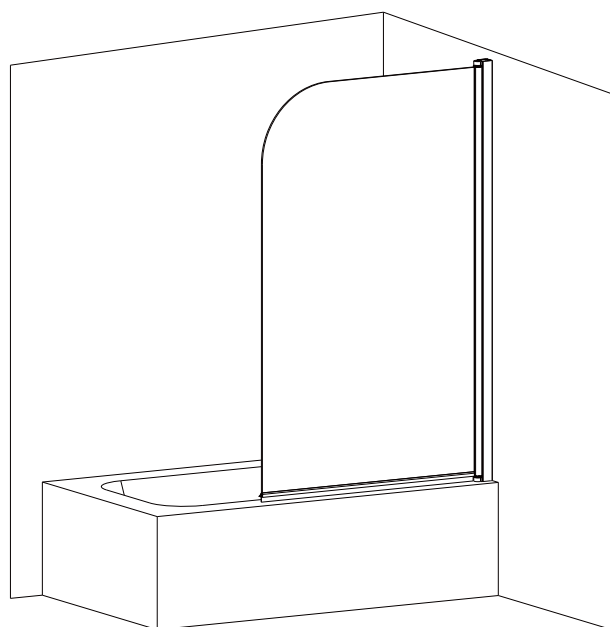

Right

Installation Steps

Step1

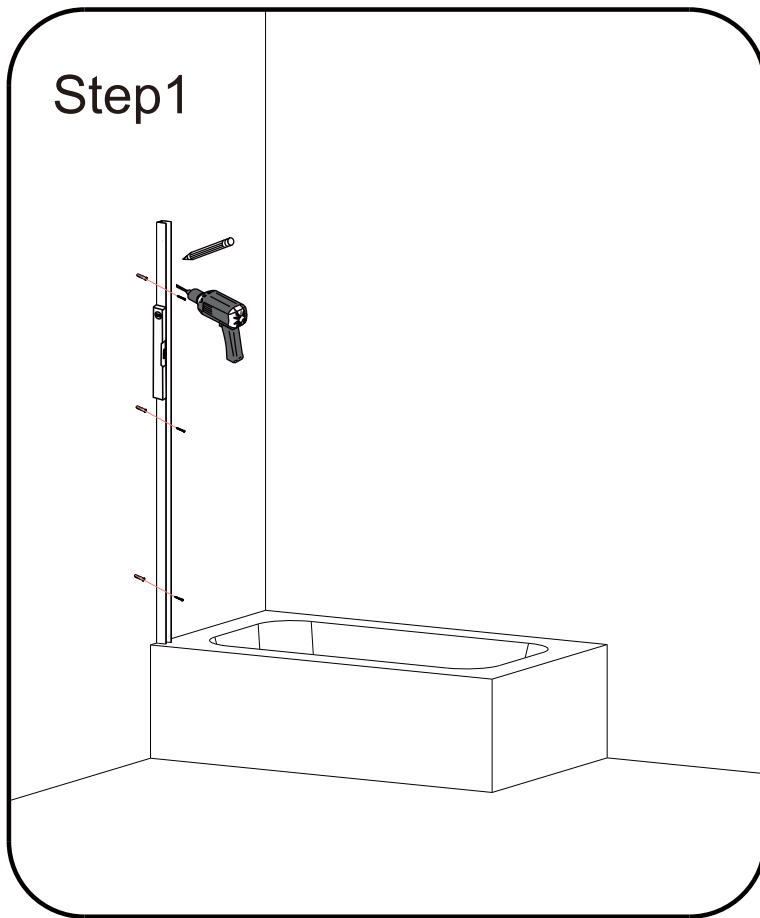

1-A

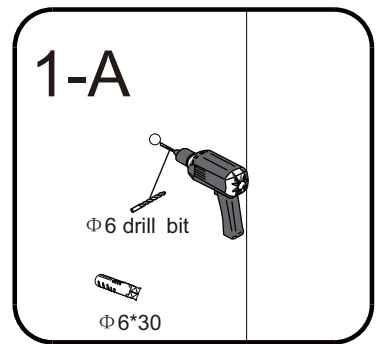

1-B

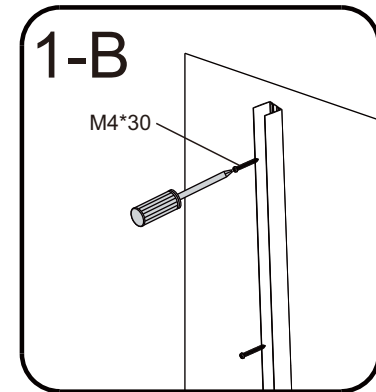

Step2

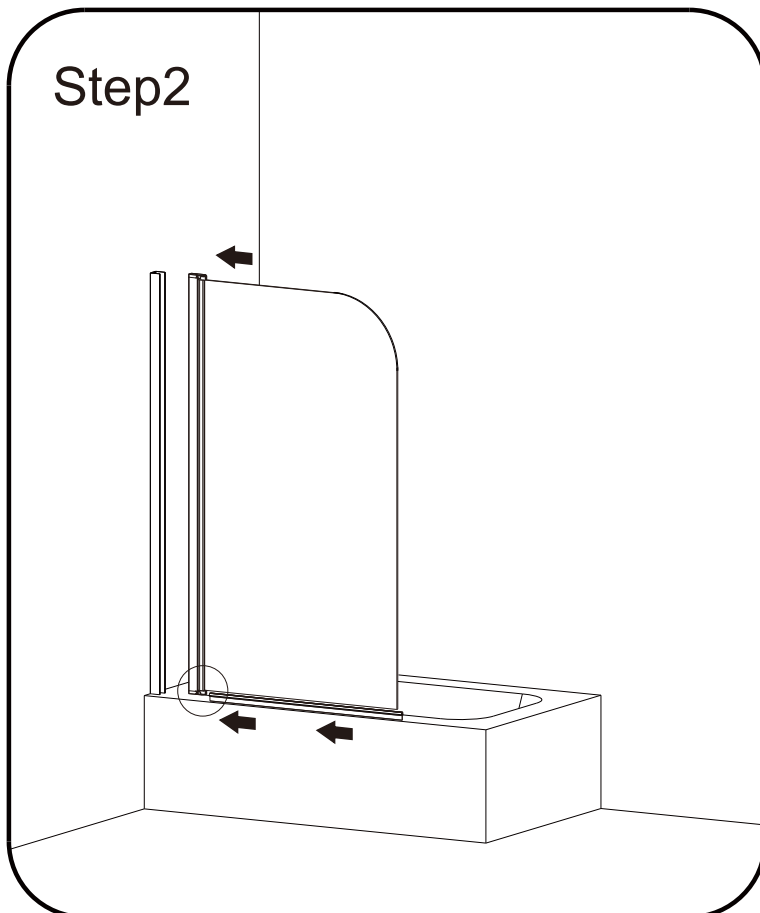

1-C

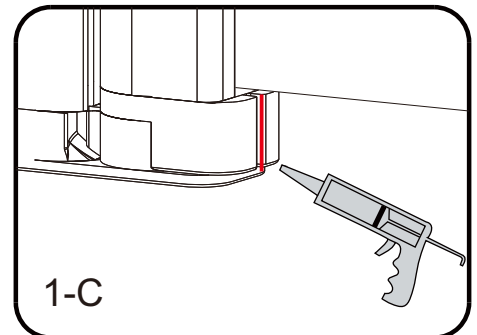

Silicone inside of the vertical slot before fitting the bottom seal strip.

1-D

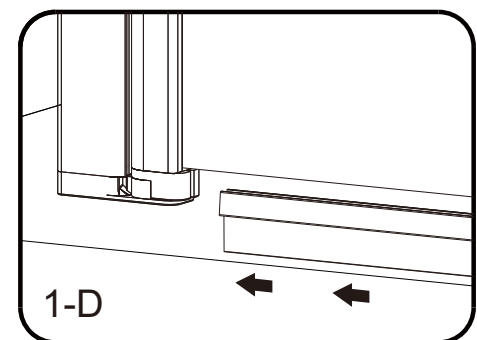

Insert bottom blade onto the glass and into the pre siliconed slot.

Step3

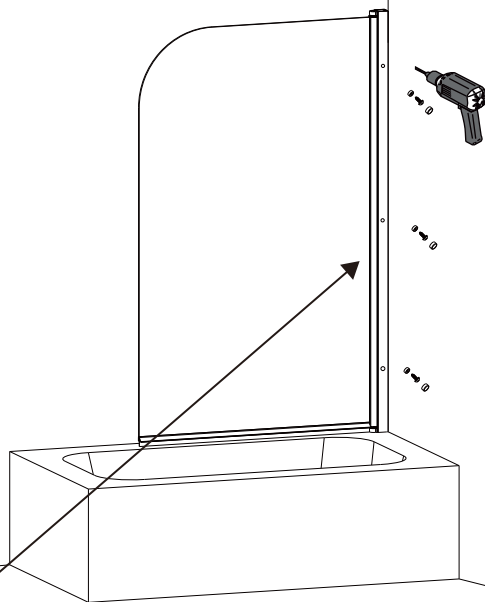

Adjust glass profile before fixing within the wall profile to ensure the bottom seal blade is parallel and in contact with the bath surface.

3-A

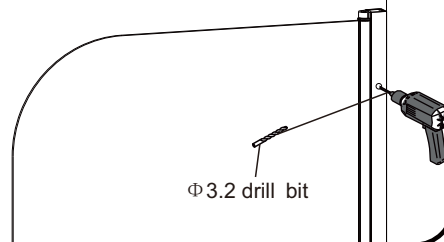

3-B

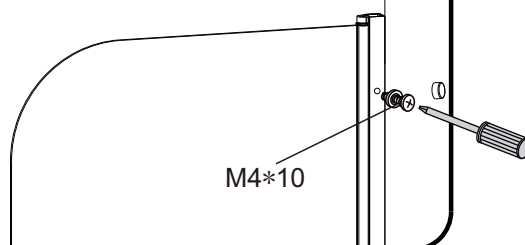

Step4

Silicone outside only where the wall profile contacts the wall.

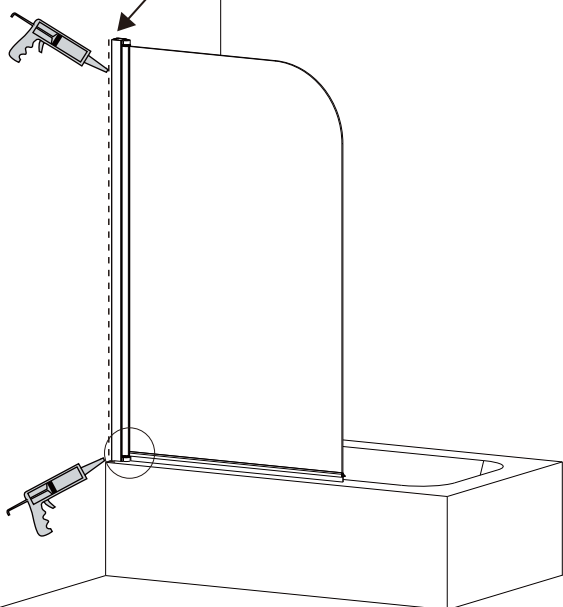

4-A

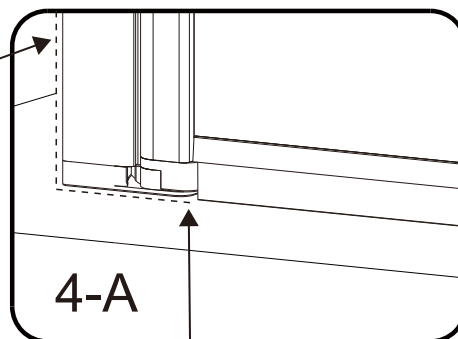

Silicone outside only along profile contact with bath edge.

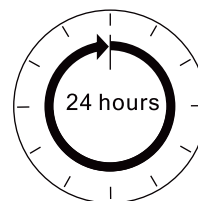

Allow 24 hours for silicone to dry before use.

Silicone on the outside edge only

NOTE any internal silicone application will invalidate your warranty.